

FAIRVIEW
PARK

Volume 3 Issue 1

Jan-Mar 2003

FAIRVIEW PARK MASTER PLAN: A GUIDE FOR TOMORROW

The Fairview Park Master Plan was established as a dynamic plan so its progress could adapt to the needs of the park and the community. With the recent news that the park had been selected by a burrowing owl for its nesting grounds, the master plan was significantly altered since its last revision. Several designated areas have been removed from the plan based upon our local resident owl, the railroad track expansion, and input from the public workshops.

Orange County Model Engineers Expansion Approved By City Council - The Orange County Model Engineers submitted a request for and received approval of an amendment to the Fairview Park Master Plan. The amendment is to allow an additional 2,250 lineal feet of railroad track that will be added to the Model Engineers' existing 8,800 lineal feet of track on the eastside of Placentia Avenue. The approved project is a logical extension of the current track system. The requested extension received approval by the Planning Commission on October 15, 2002, and by the City Council at their November 18, 2002 meeting. It is anticipated that installation of the new track will start in early 2003.

City Council Re-Confirms Fairview Park Master Plan - At the request of City Council, staff held two public workshops on July 11, 2002 and August 15, 2002 on

the Fairview Park Master Plan in order to receive input by the community. It was apparent from the feedback that the majority of the public desired a "passive park." The workshops offered the opportunity for the elements within the Master Plan to be discussed in detail between staff and members of the community and users of the Park. A comprehensive report prepared by City staff was forwarded to the Parks and Recreation Commission, as part of the public hearing process to accept further input on the Master Plan.

At the City Council meeting of November 18, 2002, the recommendations of the Parks Commission, City staff, and the public were given careful consideration. After a lengthy discussion, City Council re-confirmed the following Master Plan Elements: Model Railroad, Museum/Multi-Purpose Building, Parking Lot- Eastside, Trails, Nature Habitat, Vernal Pools, Interpretive Area, Neighborhood Park, Model Airplanes (Glider & Electric), Picnic Areas and Restrooms, and Areas A, C, D and E per Master Plan. Elements Deleted: Dog Park, Pond, BMX, Botanic Gardens, Parking Lot (northwest lowlands), Huscroft House. Now that the elements have been adopted by the City Council, implementation will move forward.

For further information or questions, please call Ron Molendyk, Fairview Park Plan Administrator at (714) 754-5303.

FAIRVIEW PARK TOUR



Join us for our series of tours that display the variation of the seasons in the park. The City of Costa Mesa's Fairview Friends Committee, will be hosting a free guided tour of Fairview Park on Saturday, January 25th, 2003. The Fairview Park Winter tour will begin at 9:30 a.m. at the south end of the main Park parking lot on the west side of Placentia Avenue, and is expected to take 1½ hours.

The tour will present an overview of what the Park has to offer the community, as well as provide public understanding regarding future plans for the Park. The Fairview Friends Committee holds seasonal tours of the park to encourage the community to witness subtle changes in the park with regard to weather and other conditions.

The tour will be conducted by Robert Graham, a long-time resident of Costa Mesa and advocate for the preservation of Fairview Park.

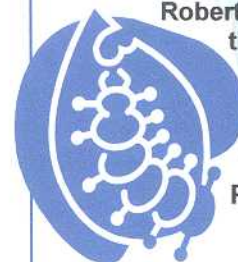

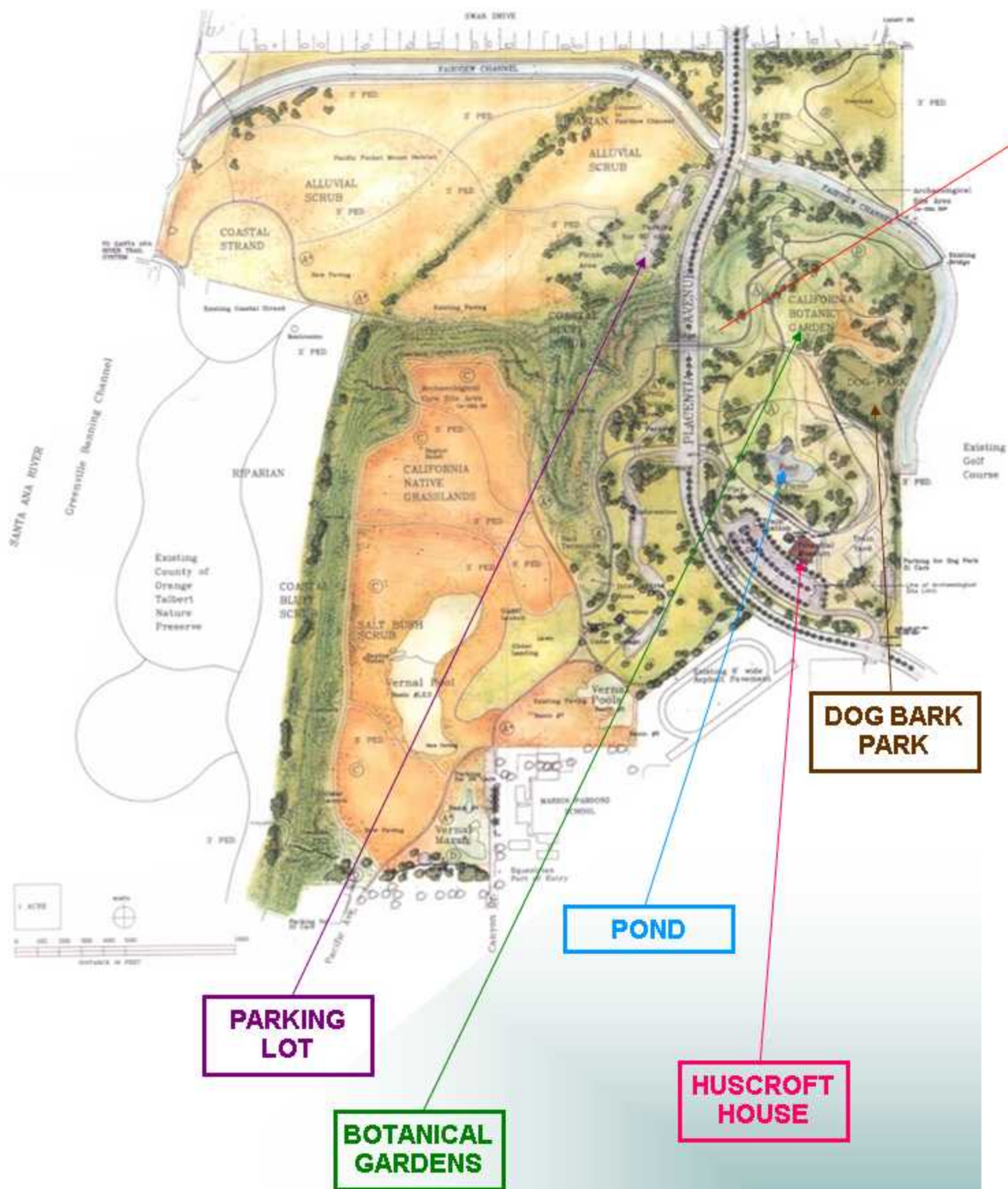

ITEMS TO BE REMOVED FROM THE MASTER PLAN

FEATURE FOCUS

BURROWING OWL

Athene cunicularia



A lone burrowing owl retreats to the east side of Fairview Park from December to March and vacations in an abandoned squirrel hole. The burrowing owl is a yearlong resident of open, dry grassland and desert habitats. They are also found as residents in grass, forb

and open shrub stages of pinyon-juniper, and ponderosa pine habitats.

The long legs distinguish this ground-dwelling owl from all other small owls. They are small owls of open country and are often seen by day standing erect on the ground or on posts. They measure 9 to 11 in (23 to 28 cm), about the size of a screech owl. The adult is boldly spotted and barred, whereas, the juvenile is buffy below. The males tend to be paler in color and proportionately larger in size than the females.



The head is rounded, there are no ear tufts, the eyes are yellow, they have whitish eyebrows, a white chin stripe, and the tail is short. When agitated, the head bobs or the owl bows with a quick bending motion of the legs. Also when agitated, their alarm call very effectively imitates the sound of a rattlesnake.

Although these owls are often considered to be diurnal, they are almost entirely nocturnal, or at least crepuscular (active at dawn and dusk). They are generally considered to be diurnal because they frequently perch conspicuously during daylight hours, especially early morning and late afternoon, at or near the entrance to their burrow or on a nearby low post. During the period when they have nestlings or recently fledged young, one or both owls are usually perched on guard very near the entrance to the nest burrow.

This ground owl preys mostly on insects, small mammals, reptiles, birds, and carrion. This owl usually hunts day and night from a perch; then hovers, displays hawk dives, and hops after prey on the ground.



The male conducts his courtship display in front of the burrow. Actual breeding occurs anywhere from March through August and the clutch size is two to ten. The young emerge from their burrow at approximately two weeks and are flying by about the fourth week.

This owl usually nests in the old burrow of a ground squirrel, badger, or other small mammal, although they may dig their own burrow in soft soil. The actual nest chamber is lined with excrement, pellets, grass, feathers, and other debris, but sometimes is unlined. Where burrows are scarce, pipes, culverts, and even nest boxes may be utilized.

Conversion of grasslands to agriculture, other habitat destruction, and poisoning of ground squirrels, has contributed to the reduction in numbers of owls in recent decades. Some of their predators include prairie falcons, red-tailed hawks, Swainson's hawks, ferruginous hawks, northern harriers, golden eagles, foxes, coyotes, and domestic dogs and cats.



HARBOR SOARING SOCIETY

HSS is committed to promoting and improving the enjoyment of R/C Soaring in Orange County. Through member participation and camaraderie they encourage the advancement of flying skills and the relaxed recreation of our membership and the R/C soaring community.

Why Join HSS?

- **Fun** - Diversity of membership creates a fun atmosphere and you haven't met a more interesting group than HSS! Our common bond is in "rising air". Come visit a General Club Meeting, join us in a Contest, or come down (as most do) to fun fly. All that we require is AMA membership to use our equipment.
- **Support** - Assistance is the key to successful first flights. HSS has a club trainer aircraft which is used to teach new HSS members safe flying skills. HSS promotes safe flying at all OC flying sites. Don't crash!
- **Contests** - HSS schedules monthly Thermal Duration contests on the first Sunday after the first Wednesday of the month. Family picnics, meets for electric and slope soaring are also scheduled through the year. Membership interests include handlaunch and scale soaring. HSS is proud of its competitive history!
- **Site Preservation** - As places to fly in Orange County disappear, it is important for all flyers to band together to support the preservation of recreational flying sites. HSS is a member of OCAMC and is the only organization maintaining contact concerning the flying status of the Estancia Bluffs/Fairview Park, the principal club flying site, with the City of Costa Mesa. Your support helps!
- **History** - HSS is recognized as the oldest AMA chartered R/C Soaring Club in the USA. Many notable personalities and their technological developments in R/C soaring have passed through HSS ranks. Gain their knowledge as a member!



How to find us:

The easiest way to find out more is to attend a HSS General Club Meeting. Meetings are held on the 1st Tuesday of the month at Irvine Water District. Or come down in the morning on the weekends to Estancia High School/Fairview Park in Costa Mesa and look for the gliders in the air...



ACTIVITY HIGHLIGHT

Friends of Fairview Park Committee

City of Costa Mesa
Costa Mesa, CA 92628

Fairview Park Friends Hotline (714) 754-5698
FairviewFriends@ci.costa-mesa.ca.us

www.cmfairviewpark.org



ACTIVITIES

Costa Mesa Historical Society (949) 631-5918
Harbor Soaring Society (949) 642-6830
Orange County Model Engineers (949) 631-3418
ReLeaf Costa Mesa (714) 540-5811

CONTACTS



(714) 754-5698
HOTLINE:
FAIRVIEW PARK FRIENDS

UPCOMING EVENTS

Every 3rd Weekend of the Month: Free train rides on the Eastside of the park provided by the Orange County Model Engineers Club

January 25th : Seasonal Park Tour @ 9:30 a.m.